



DERO

BIKE BIKE RACK

- *Attractive design*
- *great for sidewalk placement*
- *Makes a bold statement*

The Dero Bike Bike Rack is an eye-catching, functional piece of street art that playfully reminds us that we could be riding our bike today, and rewards those that do with a secure, convenient place to park it.

The Dero Bike Bike Rack forces bikes to lock up parallel with the rack, helping to keep right of ways clear. The rack allows for the wheels and frame of the bike to be secured using a u-style bike lock.



www.dero.com

1.800.298.4915



Printed on recycled paper

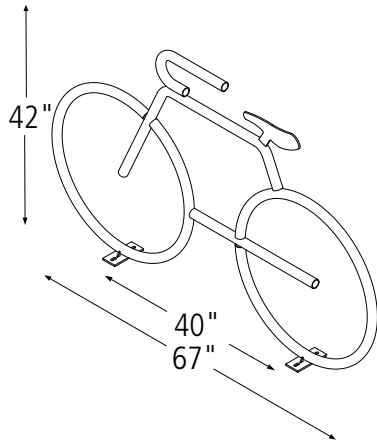

Product Dero Bike Bike Rack
As manufactured by Dero Bike Racks

Capacity 2-4 Bikes

Materials 1.5" OD 11 Gauge Tube. All open ends are capped to prevent moisture from entering. All welds are MIG welds around entire circumference of joined pieces.

Finishes An after fabrication hot dipped galvanized finish is standard. 250 TGIC powder coat colors, a thermoplastic coating and a stainless steel option are also available.

Our powder coat finish assures a high level of adhesion and durability by following these steps:

1. Sandblast
2. Iron phosphate pretreatment
3. Epoxy primer electrostatically applied
4. Final thick TGIC polyester powder coat

Stainless Steel: 304 grade stainless steel material finished in either a high polished shine or a satin finish.

Installation Methods Each rack has two 2.5" x 6" mounting brackets double gusset welded to the "wheels". The brackets are 40" apart. Each bracket is anchored to the ground with two anchors. Anchors are included with each rack

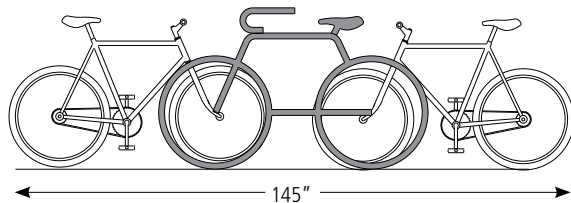

Space Use and Setbacks **Wall Setbacks:** For racks set parallel to a wall: Minimum: 24" Recommended: 36"

For racks set perpendicular to a wall: Minimum: 64" (to allow maximum capacity of 4 bikes)

Distance Between Racks: Minimum: 24" Recommended: 36"

Street Setbacks: Minimum: 36"

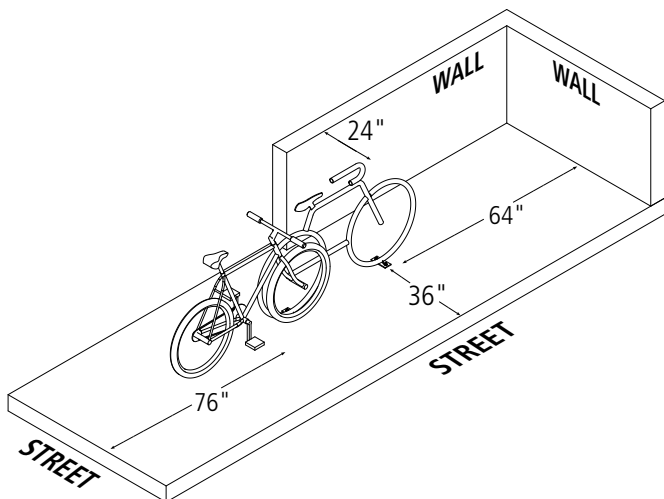



Tools Needed for Installation

- Tape Measure
- Marker or Pencil
- Masonry Drill Bit
- Drill (Hammer drill recommended)
- Hammer
- Wrench
- Level

Recommended Install Base Materials

Solid concrete is the best base material for installation. Ask your Dero Rack representative which anchor is appropriate for your application to ensure the proper anchors are shipped with your rack. Be sure nothing is underneath the base material that could be damaged by drilling.

Installation

3/8" anchors are shipped with the rack. Place the rack in the desired location. Use a marker or pencil to outline the holes of the flange onto the base material. (TIP: If installing more than one Bike Bike Rack, mark holes for each rack individually, as there may be slight differences between each rack). Drill the holes in accordance with the specifications shipped with the anchors. Make sure the holes are at least 6" away from any cracks in the base material. Tap in anchors and follow your specific anchor instructions provided with the rack.

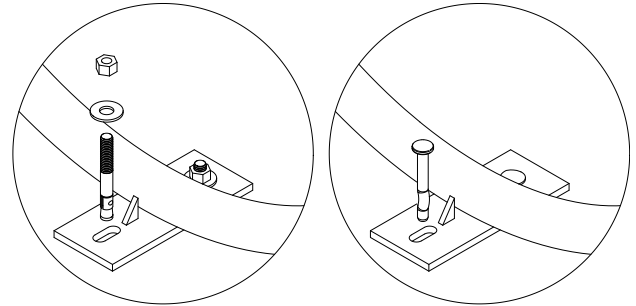

Wedge Anchor

Concrete Spike

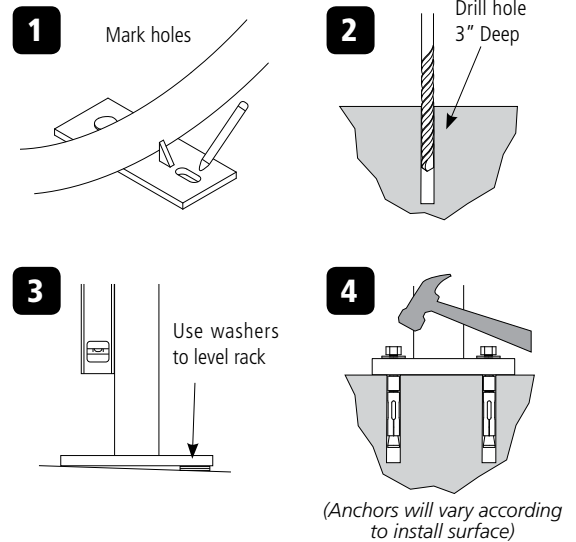

Tamper Resistant Fasteners

More so than standard racks, the Bike Bike Rack may be a target for theft. Therefore we recommend using a fastener that can't be removed by thieves. The concrete spike is a permanent anchor. The top of the wedge anchor can also be pounded sideways after installation so that it cannot be removed. Other tamper resistant fasteners can also be purchased.

When using the special tamper resistant nuts, always set and first tighten the anchors using the standard nuts included with the anchors. Once the rack is installed, replace two nuts from the bracket (opposite sides from each other) with the tamper resistant fastener. DO NOT OVER-TIGHTEN the tamper resistant nut.

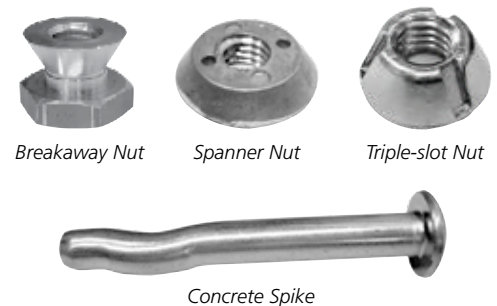

If you have any questions about installation or other features of the Bike Bike Rack, please call us toll free at 1-800-298-4915



Include Your Organization's Logo!

While the Bike Bike Rack makes a bold statement about bike parking, why not include a bold statement about yourself? Dero Bike Racks can reproduce your logo into the front wheel of the Bike Bike Rack. Logos can be cut from .25" plate steel and welded to the rack for maximum durability.

Of course logos are not the only type of image that can be included with the rack. Why not order a sign that says "Bike Parking", or the name of your city? The possibilities are endless. Contact Dero Bike Racks toll free for pricing of custom imagery: 1-800-298-4915.

